

A [6] - 150W HPS DG MS2

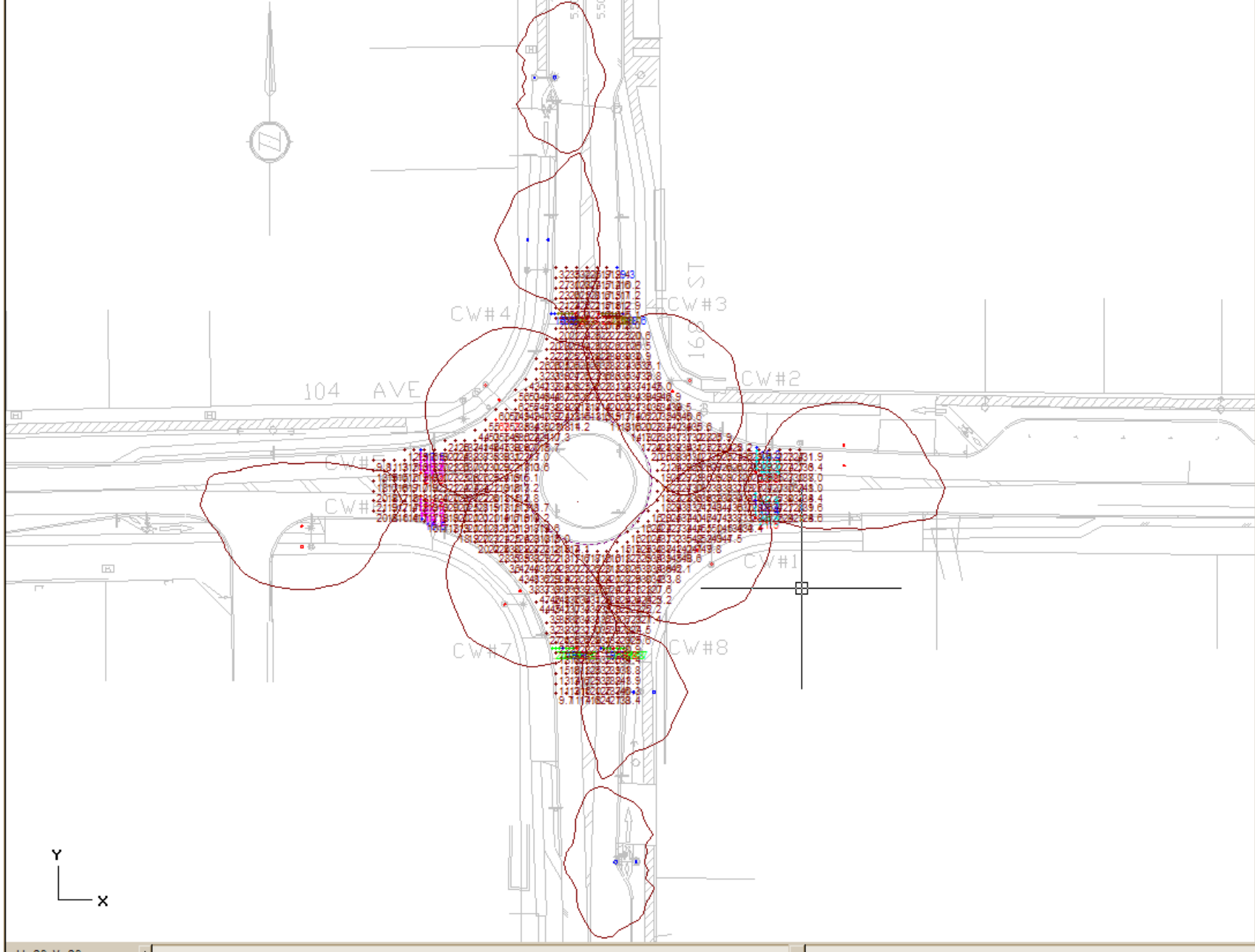

Statistics	
	East Approach X-Walk
<b>Average</b>	20.1 lux
<b>Maximum</b>	21.5 lux
<b>Minimum</b>	19.4 lux
<b>Max/Min</b>	1.1:1
<b>Average/Min</b>	1.0:1
	East Approach X-Walk
<b>Average</b>	20.0 lux
<b>Maximum</b>	23.8 lux
<b>Minimum</b>	15.3 lux
<b>Max/Min</b>	1.6:1
<b>Average/Min</b>	1.3:1
	North Approach X-Walk
<b>Average</b>	20.3 lux
<b>Maximum</b>	22.1 lux
<b>Minimum</b>	18.6 lux
<b>Max/Min</b>	1.2:1
<b>Average/Min</b>	1.1:1
	North Approach X-Walk
<b>Average</b>	20.0 lux
<b>Maximum</b>	25.0 lux
<b>Minimum</b>	16.6 lux
<b>Max/Min</b>	1.5:1
<b>Average/Min</b>	1.2:1
	Roundabout

Toolbar with icons for file operations, editing, and calculations. A status bar at the bottom of the toolbar shows 'A [0] - 150W HPS DG MS2' and a scale of '0.1'.

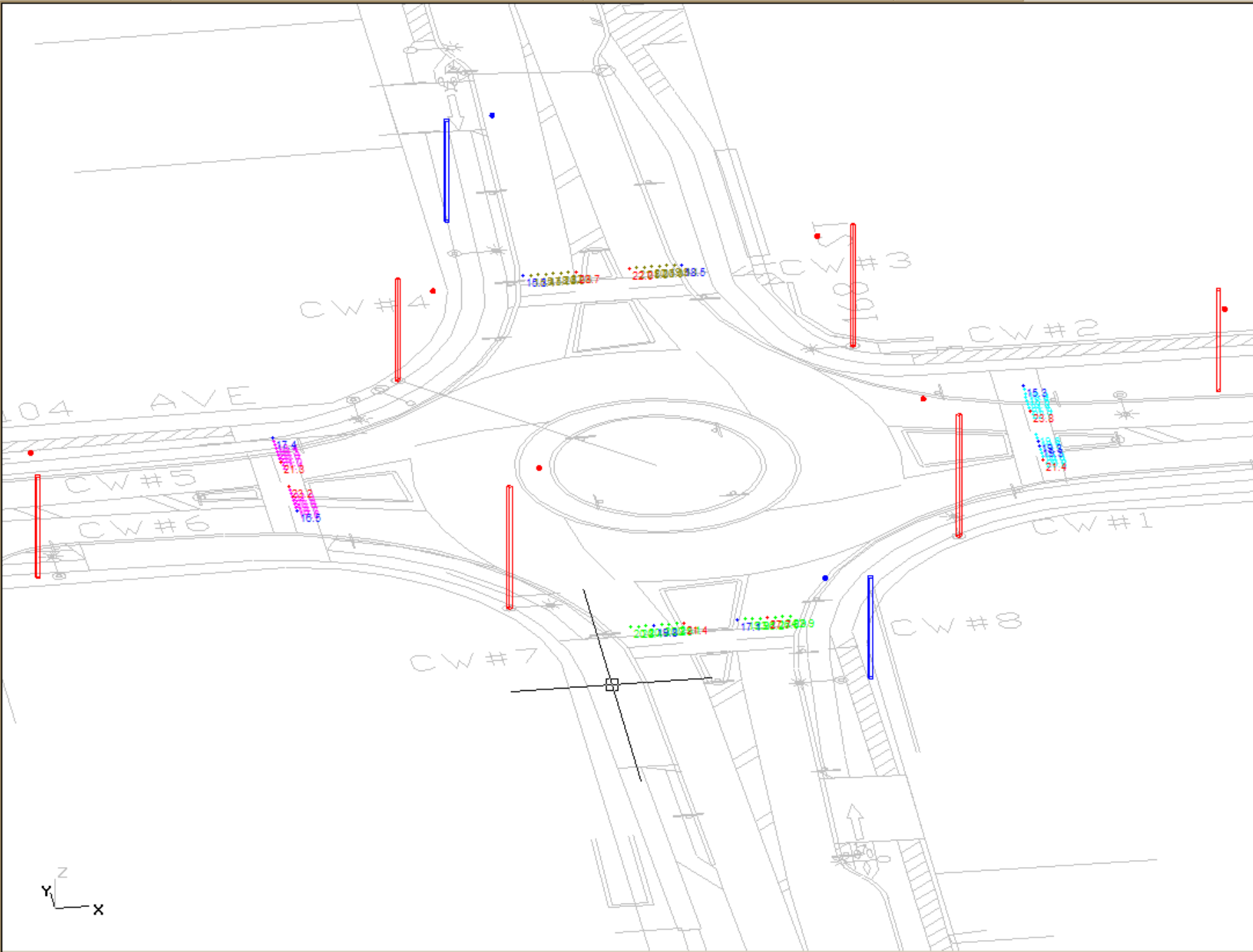

Statistics

East Approach X-Walk	
<b>Average</b>	20.0 lux
<b>Maximum</b>	21.4 lux
<b>Minimum</b>	19.3 lux
<b>Max/Min</b>	1.1:1
<b>Average/Min</b>	1.0:1
East Approach X-Walk	
<b>Average</b>	20.0 lux
<b>Maximum</b>	23.8 lux
<b>Minimum</b>	15.3 lux
<b>Max/Min</b>	1.6:1
<b>Average/Min</b>	1.3:1
North Approach X-Walk	
<b>Average</b>	20.3 lux
<b>Maximum</b>	22.0 lux
<b>Minimum</b>	18.5 lux
<b>Max/Min</b>	1.2:1
<b>Average/Min</b>	1.1:1
North Approach X-Walk	
<b>Average</b>	18.6 lux
<b>Maximum</b>	23.7 lux
<b>Minimum</b>	15.3 lux
<b>Max/Min</b>	1.5:1
<b>Average/Min</b>	1.2:1
South Approach X-Walk	

A [0] - 150W HPS DG MS2

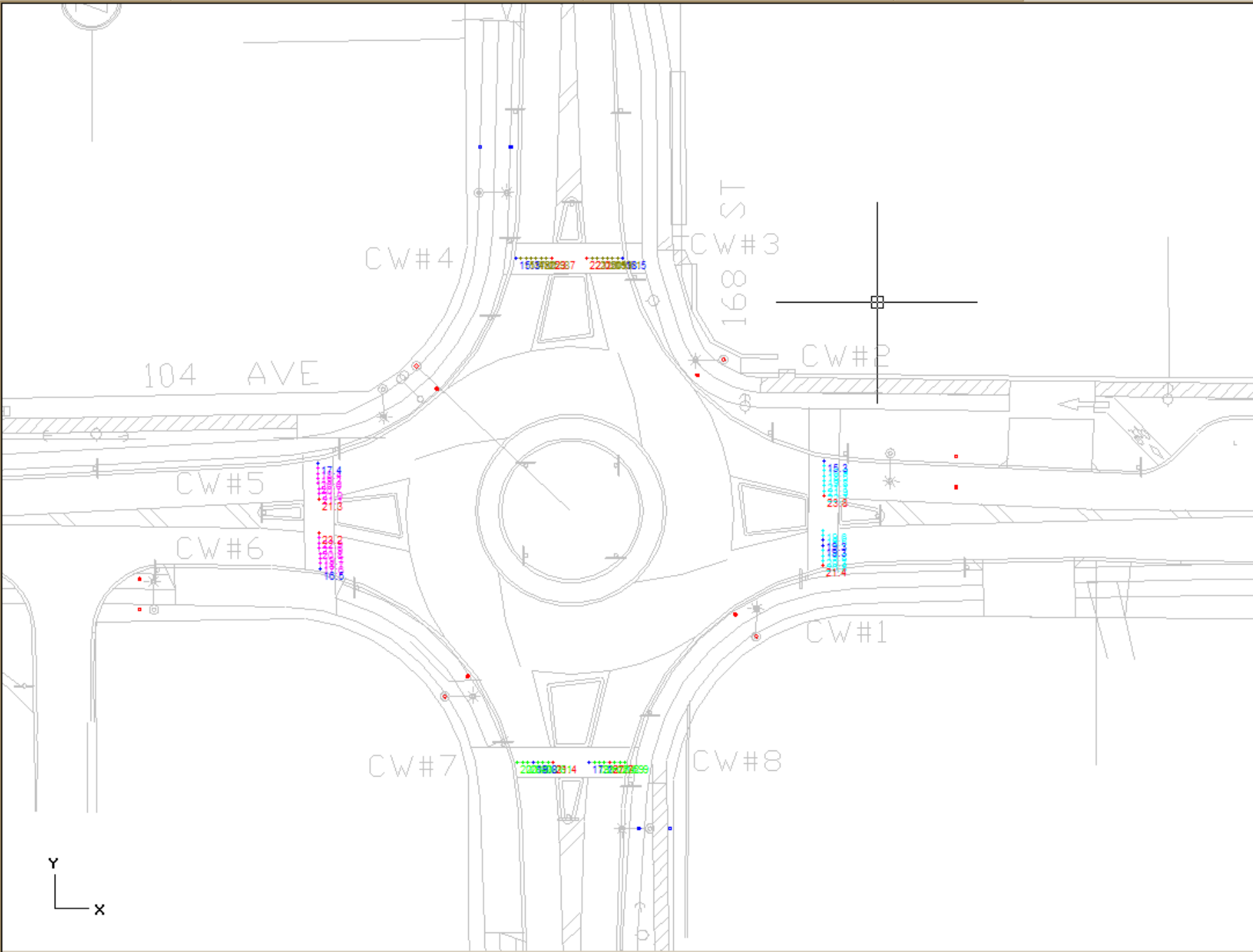

Approach	Average (lux)	Maximum (lux)	Minimum (lux)	Max/Min Ratio	Average/Min Ratio
East Approach X-Walk	20.0	21.4	19.3	1.1:1	1.0:1
East Approach X-Walk	20.0	23.8	15.3	1.6:1	1.3:1
North Approach X-Walk	20.3	22.0	18.5	1.2:1	1.1:1
North Approach X-Walk	18.6	23.7	15.3	1.5:1	1.2:1
South Approach X-Walk	18.6	23.7	15.3	1.5:1	1.2:1

F [6] - 250W HPS FG MC2

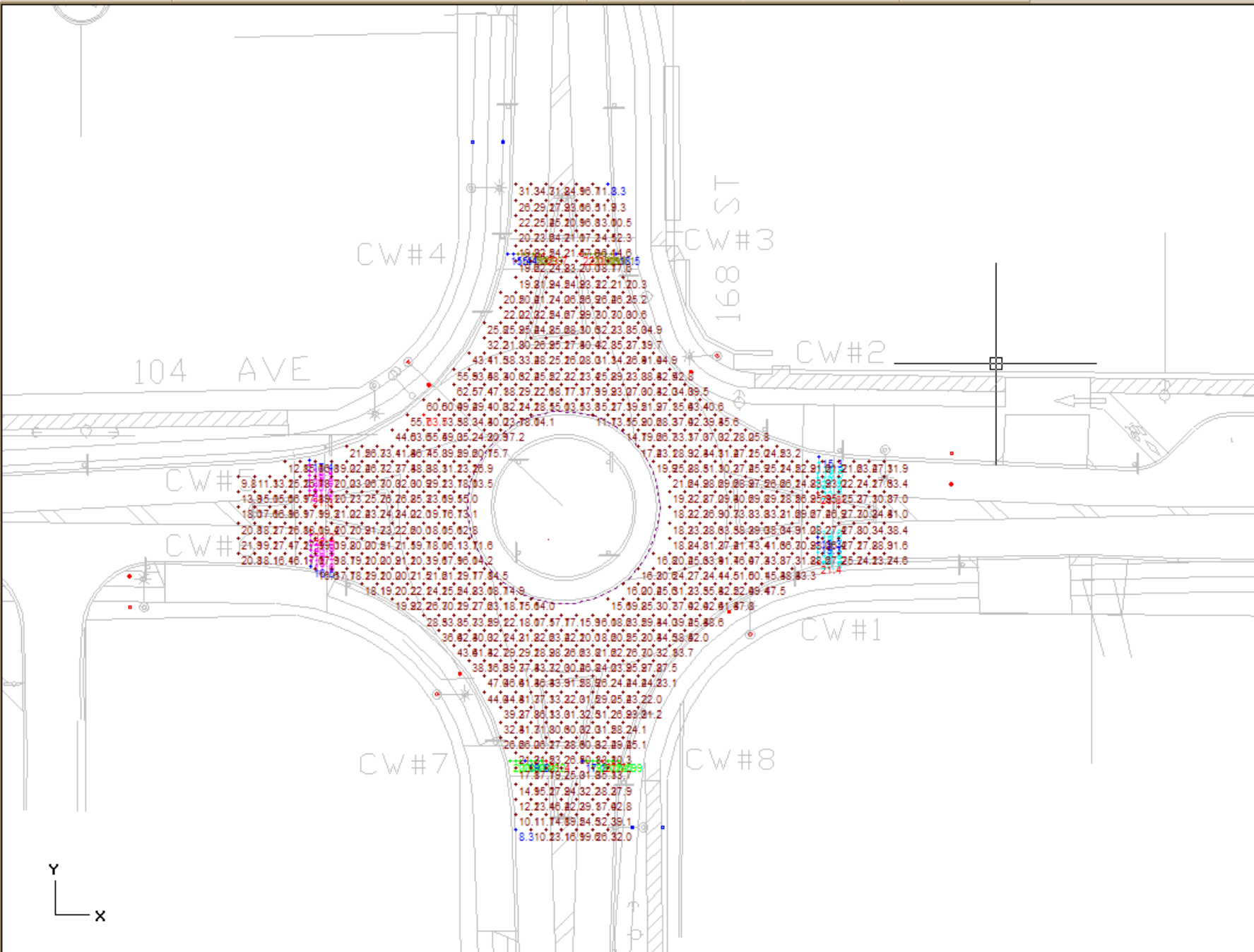

Statistics	
<b>Roundabout</b>	
<b>Average</b>	27.2 lux
<b>Maximum</b>	63.7 lux
<b>Minimum</b>	8.3 lux
<b>Max/Min</b>	7.7:1
<b>Average/Min</b>	3.3:1
<b>South Approach X-Wa</b>	
<b>Average</b>	23.5 lux
<b>Maximum</b>	27.7 lux
<b>Minimum</b>	17.1 lux
<b>Max/Min</b>	1.6:1
<b>Average/Min</b>	1.4:1
<b>South Approach X-Wa</b>	
<b>Average</b>	20.6 lux
<b>Maximum</b>	21.4 lux
<b>Minimum</b>	19.8 lux
<b>Max/Min</b>	1.1:1
<b>Average/Min</b>	1.0:1
<b>West Approach X-Wa</b>	
<b>Average</b>	20.2 lux
<b>Maximum</b>	23.2 lux
<b>Minimum</b>	16.5 lux
<b>Max/Min</b>	1.4:1
<b>Average/Min</b>	1.2:1
<b>West Approach X-Wa</b>	

Toolbar with icons for file operations, navigation, and calculation. Below the toolbar, a status bar shows 'A [6] - 150W HPS DG MS2' and a scale of '0.1'.

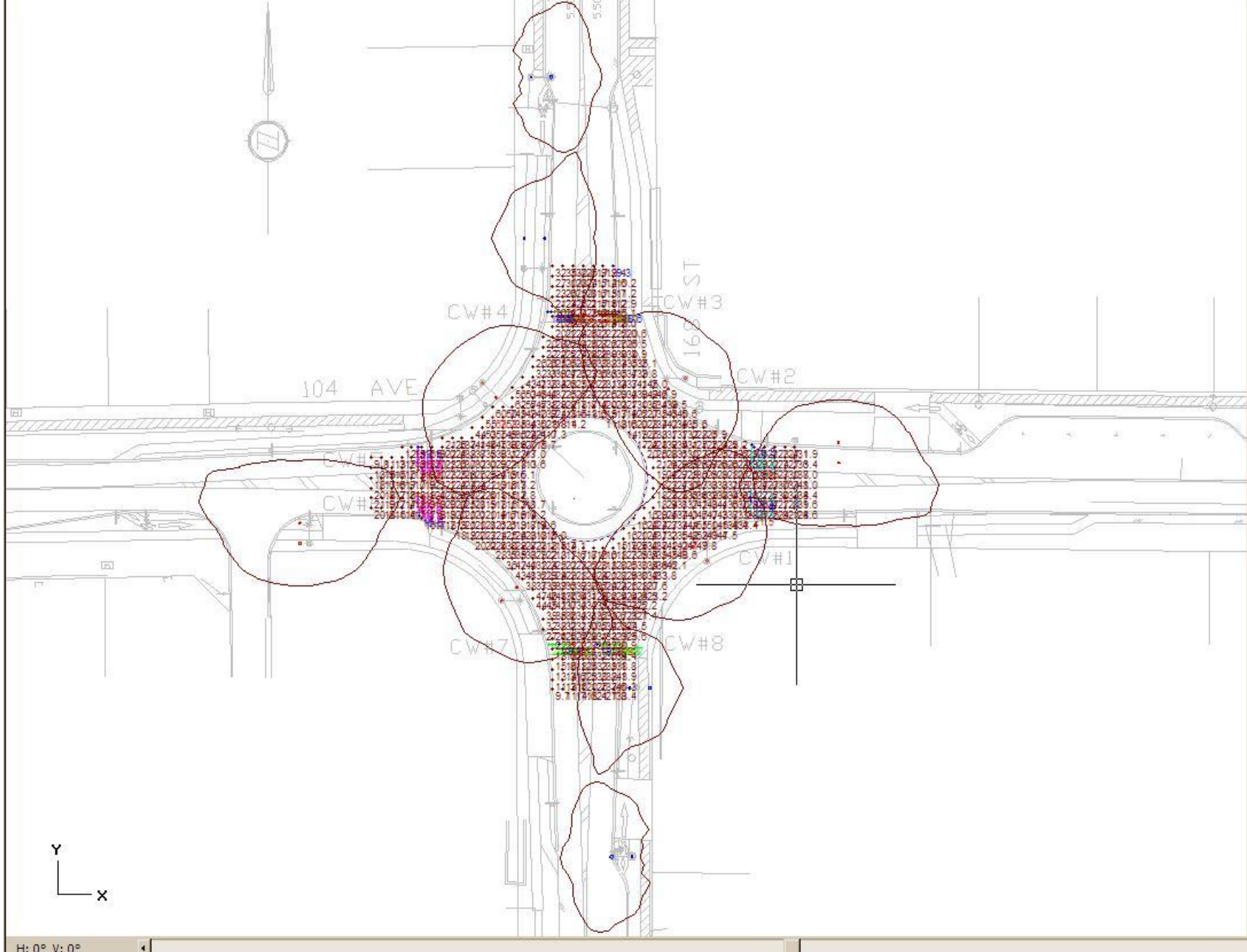

Statistics	
<b>East Approach X-Walk</b>	
Average	20.1 lux
Maximum	21.5 lux
Minimum	19.4 lux
Max/Min	1.1:1
Average/Min	1.0:1
<b>East Approach X-Walk</b>	
Average	20.0 lux
Maximum	23.8 lux
Minimum	15.3 lux
Max/Min	1.6:1
Average/Min	1.3:1
<b>North Approach X-Walk</b>	
Average	20.3 lux
Maximum	22.1 lux
Minimum	18.6 lux
Max/Min	1.2:1
Average/Min	1.1:1
<b>North Approach X-Walk</b>	
Average	20.0 lux
Maximum	25.0 lux
Minimum	16.6 lux
Max/Min	1.5:1
Average/Min	1.2:1
<b>Roundabout</b>	

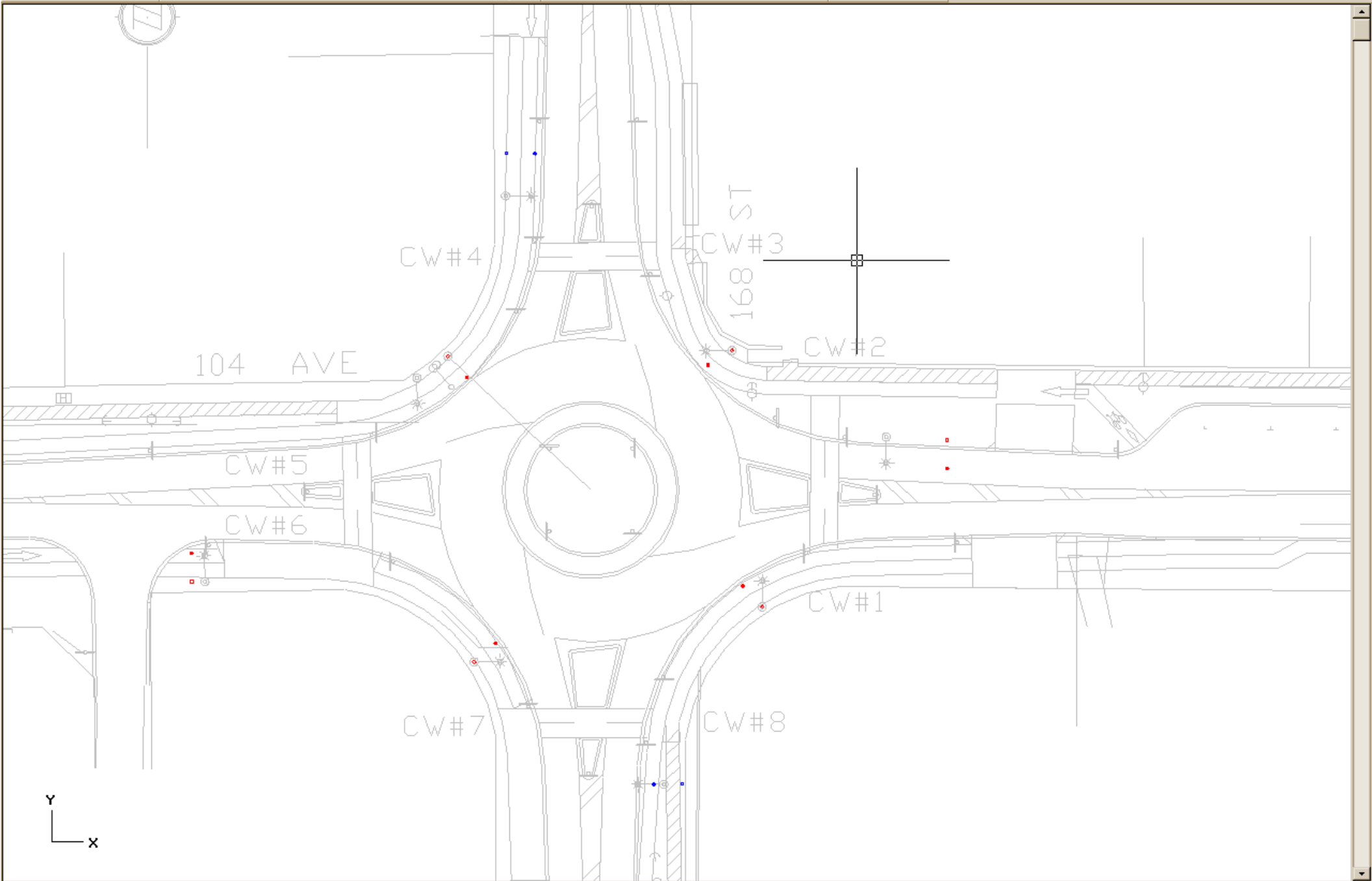

**Roadway**

Number of Lanes [L]

Lane Width [L]  m

Median Width  m

Number of Lanes [R]

Lane Width [R]  m

**Classification**

Method

Pavement

Road

Pedestrians

**Units**

Feet 
  Meters

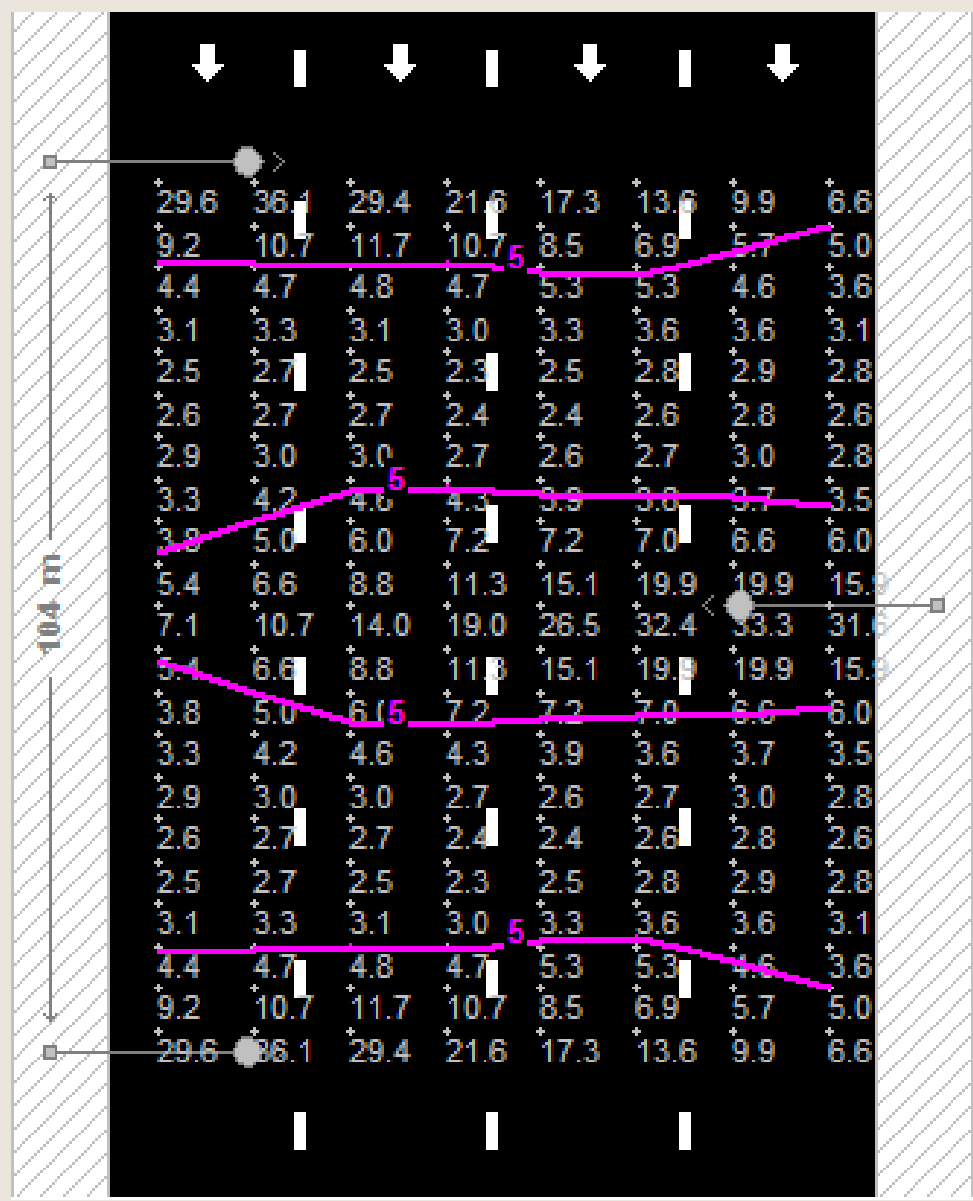

**Results - IES**

Luminance

Avg [0.4] 0.5 cd/m<sup>2</sup>  
 Max 1.3 cd/m<sup>2</sup>  
 Min 0.1 cd/m<sup>2</sup>  
 A/M [4.0] 5.0  
 M/M [8.0] 13.0

Illuminance

Avg [6.0] 7.5 lux  
 Max 36.1 lux  
 Min 2.3 lux  
 A/M [4.0] 3.3  
 M/M 15.7

Lv Ratio [0.4] 0.3

STV [2.7] 4.0

**Spacing** 104 m

**Quantity** 20

**Display**

Values 
  Contours

**Grid Location**

Left 
  Right

**Roadway**

Number of Lanes [L]

Lane Width [L]  m

Median Width  m

Number of Lanes [R]

Lane Width [R]  m

**Classification**

Method  ▾

Pavement  ▾

Road  ▾

Pedestrians  ▾

**Units**

Feet
  Meters

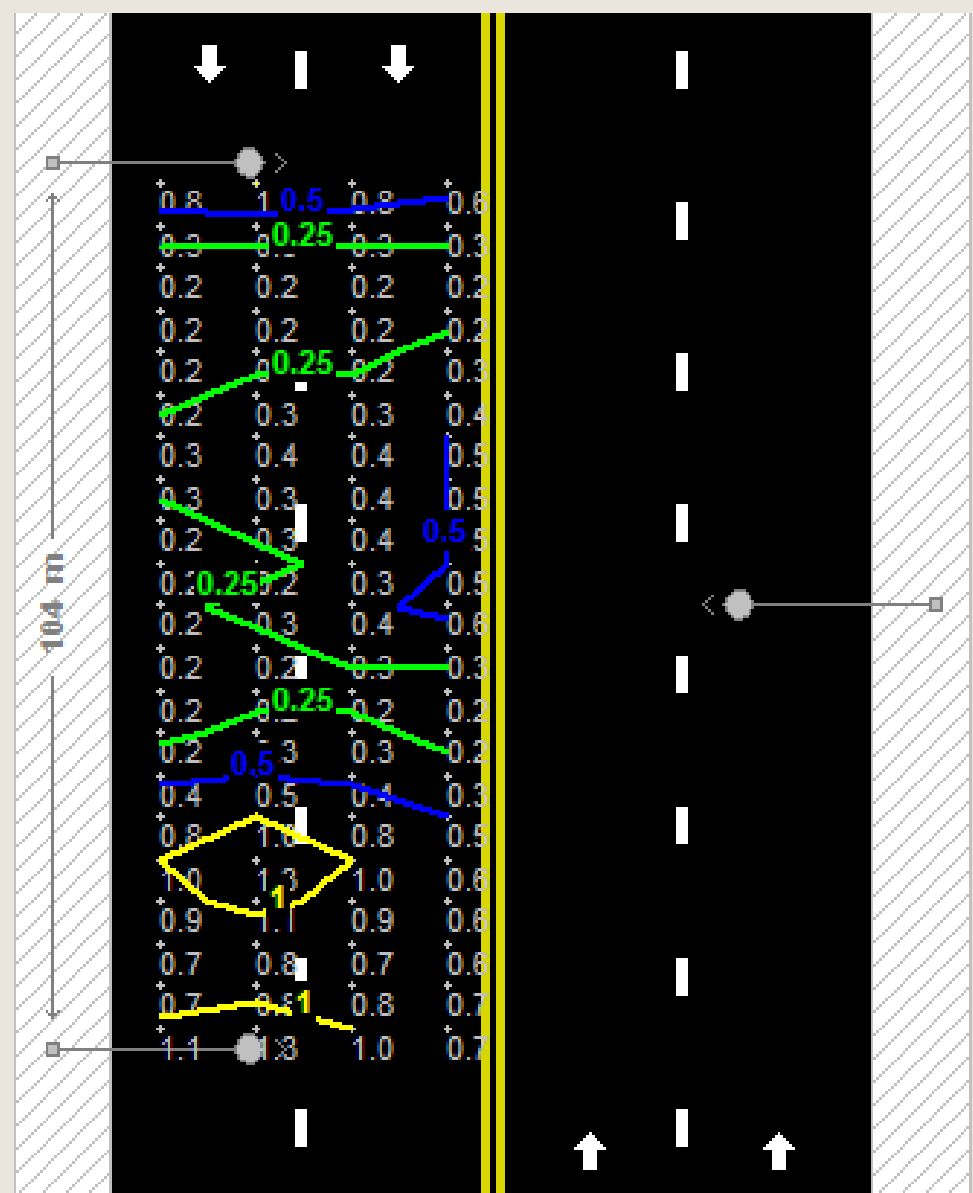

**Results - IES**

Luminance

Avg	[0.4]	0.5 cd/m <sup>2</sup>
Max		1.3 cd/m <sup>2</sup>
Min		0.2 cd/m <sup>2</sup>
A/M	[4.0]	2.5
M/M	[8.0]	6.5

Illuminance

Avg	[6.0]	7.6 lux
Max		36.1 lux
Min		2.3 lux
A/M	[4.0]	3.3
M/M		15.7

Lv Ratio [0.4] 0.3

STV [2.7] 4.0

**Spacing** 104 m

**Quantity** 20

**Display**

Values  Contours

**Grid Location**

Left  Right